



WILGER

Better Engineered Sprayer Components for Over 45 Years

New Product

COMBO-RATE Swivel Body

Initial Bulletin Date: March 1, 2022

Bulletin Reference: 220301-01

Revised: May 1, 2025

COMBO-RATE® Fence Row & Swivel Body

Stackable end body, adjustable in 15° increments

End bodies that can be fixed in 15° increments for fence-row & crop adapted spraying applications. Attaches to any COMBO-CLIP female port.



[side view]

41137-00

Can be fixed¹
in 15°
increments for
angled spray

**Angled for fence row spraying or
crop-adapted angled spraying**



[back view]

Swivel End Body without nut for
PWM or shut-off solenoid
(or equivalent)

COMBO-RATE Swivel End Bodies [Connects to any Combo-Rate female ports]			
Dia.Check Valve	Manual ON/OFF	Air-Off Operated	PWM (w/o nut)**
41102-00	41112-00	41127-00	41137-00

Common usage:

Using control module/solenoid to actuate fence-row nozzle application.

Attaches to any COMBO-RATE u-clip port

¹Note on adjust-ability - Some sprayer manufacturers choose to have swivel end bodies permanently glued to position/angle. These swivel end bodies would NOT be adjustable, and removal of glue and re-adjustment would void warranty.



[Example view with
third-party control
solenoid* mounted on
41137-00]

*Solenoids must be compatible with
Wilger module thread and nozzle body

New Product

COMBO-RATE Swivel Body

Bulletin Date: March 1, 2022
Bulletin Reference: 220301-01

COMBO-RATE® Fence Row & Swivel Body Product Drawing

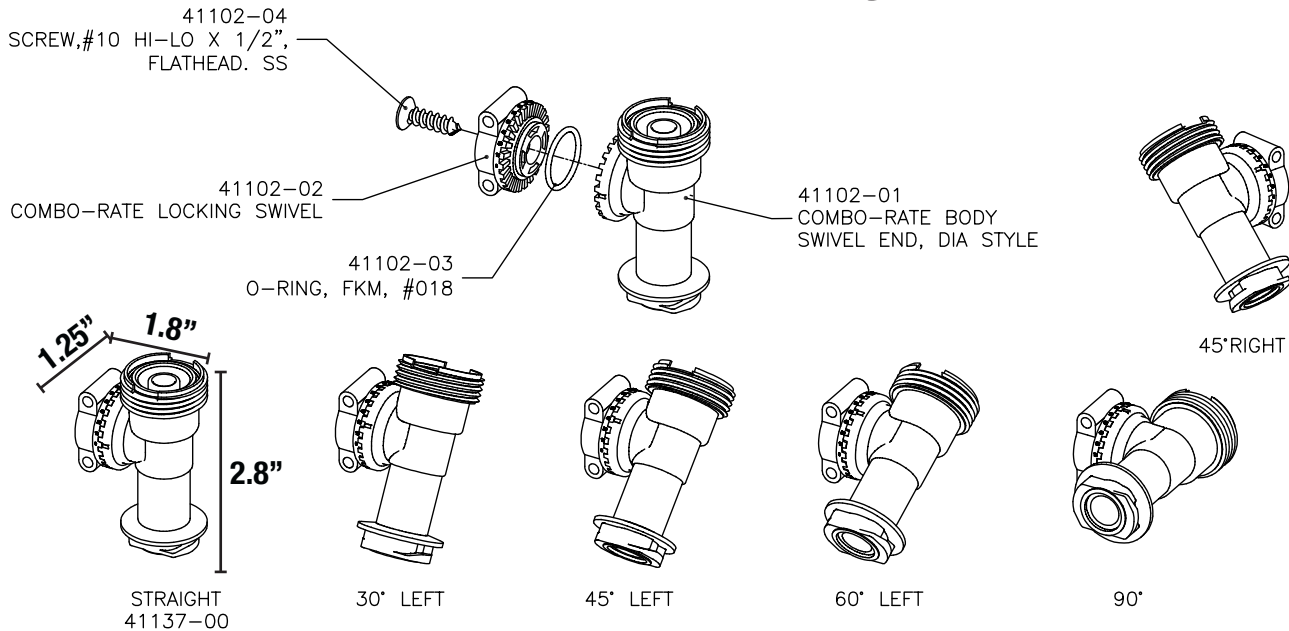

A new COMBO-RATE end body that provides a swivel joint that is **available to be locked in 15° increments!** for crop adapted spraying or fence-row nozzle spraying.

¹Note on adjust-ability - Some sprayer manufacturers choose to have swivel end bodies permanently glued to position/angle. These swivel end bodies would NOT be adjustable, and removal of glue and re-adjustment would void warranty.

Product Weight: 28g (0.028kg) Operating Pressure: 10-125PSI

Materials: Glass-reinforced Polypropylene, FKM (seal), stainless steel (screw)

PART NO.	41137-00	R2
ITEM DESC.	COMBO-RATE SWIVEL END BODY, NO NUT	
		www.wilger.net

Compatible Check Valve or Control Module Options

Wilger has a variety of check valves or control modules that are compatible with this product.

Consult the module options for the desired function.

Manual ON/OFF Check Valve

When **'ON'**, acts as a check valve.
When **'OFF'**, shuts off flow.



Available in 4PSI, 10PSI, or 15PSI check valve strength

Diaphragm Check Valve

Standard check valve opens at a certain pressure.
(10 PSI standard)



Available in 4PSI, 10PSI, or 15PSI check valve strength

Air-OFF Module

When sufficient air pressure is sent to check valve, check valve is forced closed.



Available in 4PSI, 10PSI, or 15PSI check valve strength

No Module

No module is typically used when a PWM solenoid or electronic shut-off is used.*



A module is required for proper operation.

 **CANADA**
Wilger Industries Ltd.
Site 412, Box 280, RR#4
Capital Circle W & Auction Mart Rd.
Saskatoon, SK, Canada S7K 3J7
Phone: 1 (833) 242-4121
Fax: (306) 242-4122
Email: info@wilger.net

 [@WilgerParts](https://twitter.com/WilgerParts)

 **UNITED STATES**
Wilger Inc.
255 Seahorse Drive
Lexington, TN, USA
38351-6538
Phone: (877) 968-7695
Fax: (877) 968-7613
Email: WilgerEsc@WilgerEsc.com

 [@WilgerInc](https://twitter.com/WilgerInc)

 **ARGENTINA**
Wilger Argentina
Mitre 699
San Nicolas (2900)
Buenos Aires, Argentina
Phone: +54 9 336 4596710
Email: cjporras@gmail.com

**Focused on Application
Performance for
Over 45 Years**

www.wilger.net

All Wilger trademarks and logos are owned by Wilger Industries Ltd. All other brand or product names are trademarks or registered marks of their respective owners. All rights reserved.